

- General Notes**
1. Ceiling is 3.5m high through all units
  2. All floors are to be tiled
  3. Tiling to all kitchen walls to a height of 1.8m
  4. Coving to wall / floor edges
  5. All floors in kitchens are tiled 300 x 300mm
  6. All lighting throughout is to be fluoro fittings

- Legend**
- Gas Bayonet x 2 of gx2
  - Water Outlet w
  - Tap next to sinks for washdown tp
  - Ceiling Mounted Exit Sign
  - Emergency Light
  - Smoke Detector S
  - Bucket Trap (Ø100)

To Disabled WC:  
provide effects shelf,  
clothes-hanging device,  
soap dispenser & paper towel  
dispenser to comply with  
Clause 15.4 of AS1428.1-2009  
provide grabrails to disabled wc,  
complying with AS1428.1-2009

provide handrails to each side  
of ramp to comply with  
Clause 12 of AS1428.1-2009

provide mechanical  
ventillation to toilets

provide TGSIs & non-slip  
surface to ramp to comply  
with AS1428.4.1-2009

provide TGSIs & non-slip  
surface to ramp to comply  
with AS1428.4.1-2009

**Proposed Layout Plan**  
scale 1:100

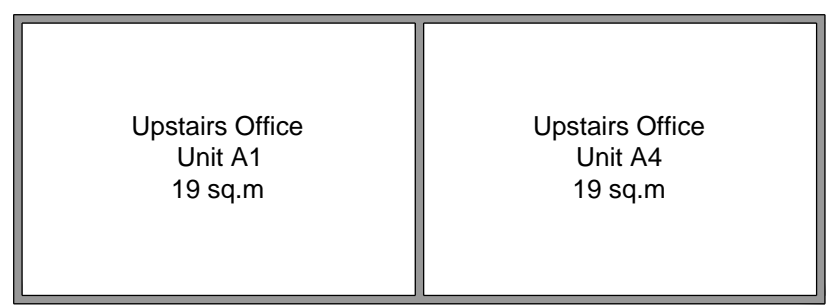

**Upstairs Offices**

Rev.	Description	Date
L	generally amended & notes added	26/08/12
M	amended at disabled access ramp	30/08/12
N	amended at disabled access ramp	04/09/12
P	disabled wc wall inline with passage wall	05/09/12
Q	disabled wc fixtures re-arranged	06/09/12
R	unit D1 external wall & room labels	19/09/12

Rev.	Description	Date
E	additional clearances at wc areas	30/07/12
F	disabled WC relocated	08/08/12
G	disabled WC relocated	13/08/12
H	room labels amended	18/08/12
J	room labels & disabled wc	21/08/12
K	room labels, disabled wc & ramp	23/08/12

**IMAGINE**  
DRAFTING SERVICES  
ABN 57 076 596 872  
Mob 0438 713 410  
Ph 02 69 713 410 email: imaginedrafting@yahoo.com.au

- new homes
- additions
- renovations
- industrial
- commercial

Client  
**Enda Hughes**  
Project  
**Food Premises**  
**Unit 1/16-12 Cross St. BROOKVALE**

Date <b>19/09/12</b>	Sheet <b>1 of 1</b>	Dr'g No. <b>1R</b>
Drawn <b>A.Barrow</b>	Scale <b>1:100 @ A3</b>	